

Blade Replacement and Locking System

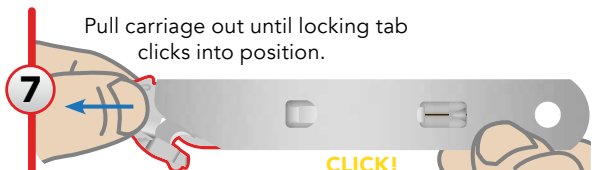
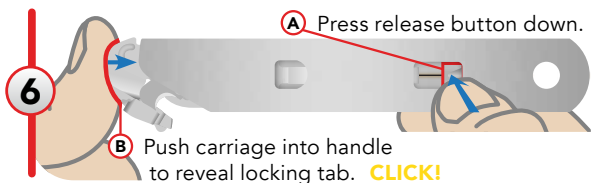
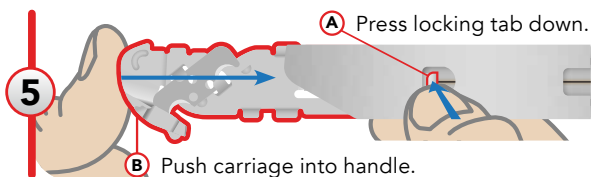
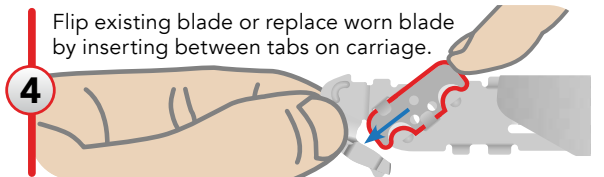
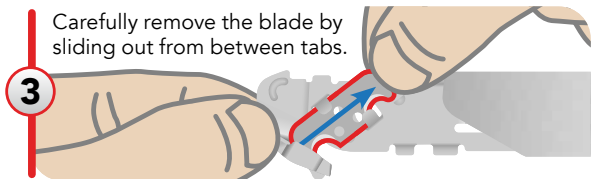
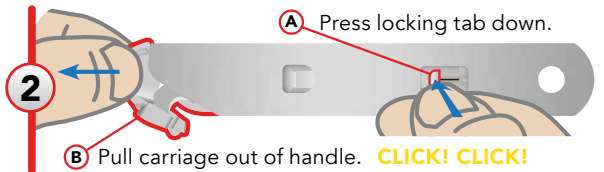
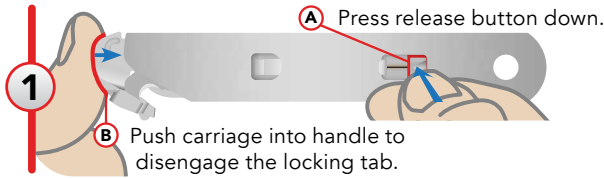

BLADE REMOVAL

CARRIAGE LOCK

Cleaning Your KS Series Safety Cutter

1 DISASSEMBLE CUTTER AND REMOVE BLADE

Follow blade removal steps #1–3 at left. Then, press locking tab down once again to pull carriage all the way out of the handle.

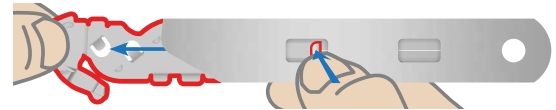

2 CLEAN HANDLE AND CARRIAGE SEPARATELY

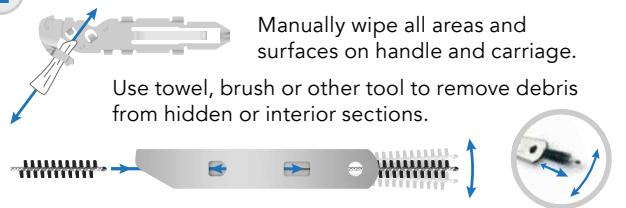

3 SANITIZE IF NEEDED FOR YOUR APPLICATION

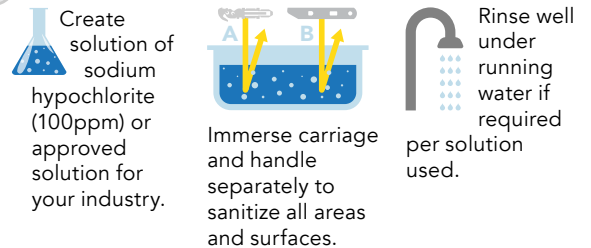

4 ONCE CLEAN AND DRY, REASSEMBLE CUTTER

Push carriage into handle until locking tab clicks once.



Insert new blade between tabs on carriage.

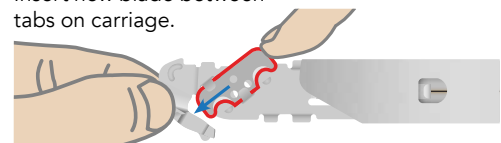

Follow carriage lock steps #5–7 at left.